

ECO Spot C60 LED Gobo Projector

Compact LED Gobo Projector for mid level Brightness and Image sizes.

- Strongest compact ECO Spot model.
- Interchangeable Projection Lenses for a wide range of applications.
- Takes metal and glass Gobos up to Full Color. No film gobos.
- Integrated, switchable Gobo Rotator.
- Universal yoke/stand-foot allows for Standalone or Truss mounting.
- Compact, full Aluminum Housing.
- Wide power Range.



SPECIFICATIONS:

Item Number: ES-C60
Line Voltage: 100-240V, 277V, 50-60Hz, 72W

Dimmable: Yes, manual dial on back plate

Lamp Type: LED 60W
Rated Bulb Life: 40,000 Hours
Color Temperature (Kelvin): 6,000k +/-500k
Effective Luminous Flux: 3,400lm (LED rated 4000lm)

Available Projection Lenses: Narrow: f=140mm/10°, Semi-Narrow: f=100mm/15°, Medium: f=70mm/20°, Wide: f=50mm/25°, Ultra Wide f=28mm/45° (max. Gobo ID: 25mm)

Gobo Dimensions: OD37.5mm, ID27mm (with provided adapter) or OD52.8mm, ID27mm
ID=Image Diameter
OD=Outer Diameter
Recommended max. ID: text ID25mm / standard ID27mm / patterns ID32mm
Gobo Types: Glass or Metal, **NO Film material**

PROJECTION RANGE (typical range with Narrow lens)

Bright environment: - up to 50ft
Dim environment: - up to 90ft
Dark environment: - up to 180ft (or more in very dark conditions)

ECO Spot C60 LED Gobo Projector

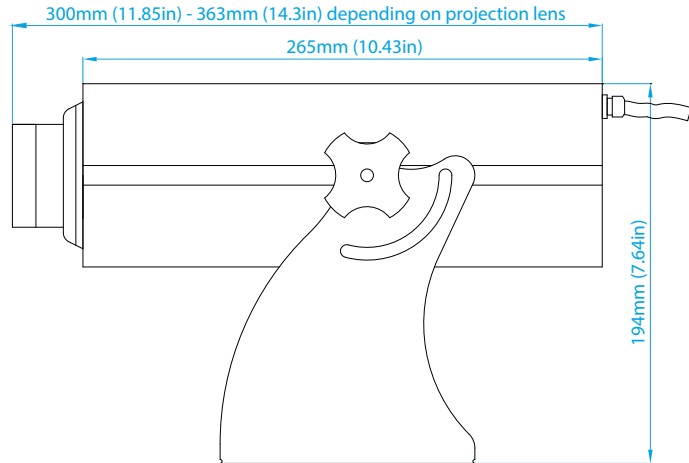
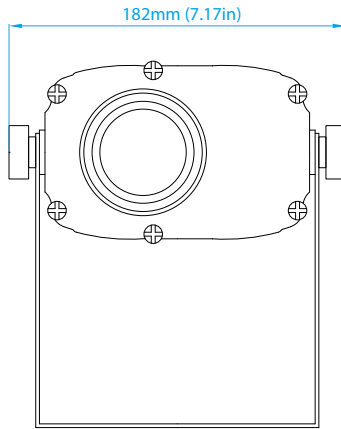

Typ. total length including the projection lens:

- Narrow: $f=140\text{mm}/10^\circ$: 363mm (14.3in)
- Semi-Narrow: $f=100\text{mm}/15^\circ$: 344mm (13.5in)
- Medium: $f=70\text{mm}/20^\circ$: 300mm (11.8in)
- Wide: $f=50\text{mm}/25^\circ$: 300mm (11.8in)
- Ultra Wide: $f=28\text{mm}/45^\circ$: 322mm (12.7in)

Projector Weight: 7lbs

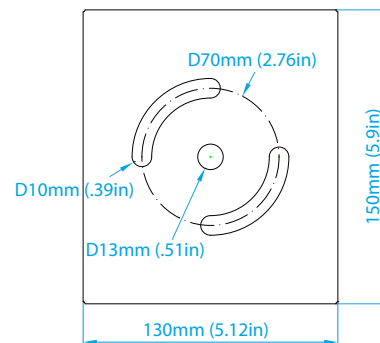

ECO Spot™ Photometrics						ECO Spot is a Trademark of Globus New Media LLC dba Gobosource																								
Model Gobo Size	Color Temp.	Lens	Beam Mult.	Effective Im	CD	Value	PROJECTION DISTANCE IN FEET (ft)																							
							3	6	9	12	15	20	24	30	36	42	64	88	112	136	200	300								
ES-C60 ES-C60E ES-C60+ ES-C60PCE	6000k +/- 500k	140mm (10")	0.18	2381	93,600	Size (ft) Brightn.(fc)				1.6	2.2	2.7	3.6	4.3	5.4	6.5	7.6	11.5	15.8	20.2	24.5	36.0								
		100mm (15")	0.26	3362	63,360	Size (ft) Brightn.(fc)			1.6	2.3	3.1	3.9	5.2	6.2	7.8	9.4	10.9	16.6	22.9	29.1	35.4									
		70mm (20")	0.35	3739	38,880	Size (ft) Brightn.(fc)			2.1	3.2	4.2	5.3	7.0	8.4	11	13	15	22	31	39										
		50mm (25")	0.45	4807	30,240	Size (ft) Brightn.(fc)			2.7	4.1	5.4	6.8	9.0	11	14	16	19	29	40	50										
28mm* (45")		0.88	5952	9,792	Size (ft) Brightn.(fc)			5.3	7.9	10.6	13.2	17.6	21.1	26.4	31.7	37.0	56.3													
								272	121	68	44	24	17	11	8	6	2													
ECO Spot is a Trademark of Globus New Media LLC dba Gobosource						Copyright ©2018 GoboSource™																								
How to Read the Illumination Values																														
Foot Candles (ft)	For a quick overview, the illumination values in the tables are color coded. There are many factors that determine the visibility of a projection, such as ambient light, color and reflectiveness of the projection surface, competing light, gobo colors, projector color temperature, and other factors. Therefore our recommendations should only be used as guidelines and we cannot guarantee a successful application. If you are unsure, please call us to discuss.																													
Projection Size Calculation	For the resulting Projection Size at any given Distance, Multiply the number in the "Beam Mult." column with your Projection Distance. Projection Size = Distance x Beam Mult. For the Distance needed to achieve a desired Projection Size, Divide the Projection size by the Beam Multiplier. Distance = Projection Size / Beam Mult.																													
300+	Extreme brightness for extremely bright environments, i.e. bright areas, additionally flooded with daylight, such as Lobby-, Retail-, Trade Show-, Environment. Outdoors (shady, no direct sunlight).																													
150-300	Very high brightness for very bright environments, such as light flooded Office-, Lobby-, Retail-, Trade Show-, Environment. Color gobos project in vibrant colors. Outdoors well visible at night with vibrant colors.																													
45-150	The most common brightness bracket for bright environments, such as Office, Lobby, Retail, Tradeshow. Outdoors extremely bright at night. Color gobos project well.																													
15-45	Sufficient brightness for environments, such as Bars, Clubs, and intimate Restaurants, Theaters, and dimmed Conference rooms. Outdoors well visible at night. Color gobos should preferably be used with lighter colors and the projection surface should be light and somewhat reflective.																													
15-2	Only advisable for dark environments and subtle projection of light colored artwork, preferably on light, reflective projection surface. If all conditions are met, the max. listed image distance/size can be doubled in most cases.																													
Metric Conversions: For Meters multiply feet by .3048. For Lux multiply footcandles by 10.76																														

PACKAGE CONTENTS

Power Cord • Test Gobo • Spare Gobo Retaining Ring • Integrated Gobo Mounts • User Manual

Questions? Call us!

1-831-431-8800

www.gobosource.com